

2nd ANNOUNCEMENT

SSIEM
ANNUAL SYMPOSIUM
LISBOA 2008



SSIEM - SOCIETY FOR THE STUDY
OF INBORN ERRORS OF METABOLISM

2-5 SEPTEMBER

INDEX

WELCOME TO LISBOA	3
COMMITTEES	4
CONTACT DETAILS	5
ABOUT LISBOA	6
SYMPOSIUM VENUE	7
PRELIMINARY SCIENTIFIC PROGRAMME	8
WORKSHOPS	13
CALL FOR ABSTRACTS	14
SSIEM COUNCIL INFORMATION	15
EXHIBITION INFORMATION	16
LISBOA ACCESSIBILITY	17
REGISTRATION	19
HOTEL ACCOMMODATION	21
SOCIAL PROGRAMME	23
EXCURSION DETAILS	24
ACCOMPANYING PERSON PROGRAMME	29
SYMPOSIUM POST TOURS	33
GENERAL INFORMATION	34
FOR YOUR NOTES	36
LOCAL TRANSPORTATION INFORMATION	37
LISBOA CITY MAP	38

Dear Colleagues,

On behalf of the organising committee and the SSIEM may we extend a warm invitation to the 2008 SSIEM Annual Symposium, which will be held in Lisboa, Portugal, from 2 to 5 September. Lisboa is one of the liveliest cities in southern Europe and is also known for its warm hospitality.

2008 marks a major anniversary – one hundred years since the Croonian lecture *Inborn Errors of Metabolism* by Sir Archibald Eduard Garrod to the Royal College of Physicians, in London. The SSIEM Council decided to celebrate this landmark and therefore the Symposium theme will be Inborn Errors of Metabolism One Century after Garrod.

The scientific programme looks as stimulating as ever, offering: plenary sessions dedicated both to the main topic of this year's meeting "interactions and regulation in IEM" and to the hot topics; parallel sessions giving the opportunity to present a large number of free communications and *The Garrod Day*, with a series of lectures in honour of Sir Archibald's pioneering work. Tuesday morning will be dedicated to ERNDIM meeting and Nutrition and Dietary Treatment and Wilson's Disease workshops.

The SSIEM Symposium 2008 will take place at the riverside Lisboa Congress Centre. The venue will provide excellent facilities to accommodate a large number of poster presentations and the industry exhibitions.

Away from the seminar rooms, the local organising committee is working hard to plan a lively social programme, providing you with the chance to meet colleagues in a relaxing environment and to sample some of the history and atmosphere of Lisboa, the birthplace of so many other *Discoveries*.

We are delighted to be hosting the 2008 SSIEM Annual Symposium and very much look forward to welcoming colleagues to Lisboa.

Isabel Tavares de Almeida
President
Annual Symposium 2008



SCIENTIFIC COMMITTEE

Isabel Tavares de Almeida	Lisboa
Cornelis Jakobs	Amsterdam
Marinus Duran	Amsterdam
Margarida FB Silva	Lisboa
Aguinaldo Cabral	Lisboa
Clara Sá Miranda	Porto
Luisa Diogo	Coimbra
Elisa Leão Teles	Porto
Jorge Azevedo	Porto
Filomena Eusébio	Lisboa
Laura Vilarinho	Porto
Isabel Rivera	Lisboa
Paula Leandro	Lisboa

LOCAL ORGANISING COMMITTEE

Ana Gaspar	Lisboa
Fátima Ventura	Lisboa
Isabel Rivera	Lisboa
Margarida FB Silva	Lisboa
Margarida Noronha	Lisboa
Maria João Silva	Lisboa
Paula Leandro	Lisboa
Rita Castro	Lisboa

GENERAL INFORMATION

Registration, Hotel Accommodation, Excursions, Tours and Accompanying Person Programme

Leading Congress & Association Management
Largo da Lagoa, 15 F
2795-116 Linda-a-Velha / Lisboa
Portugal

Tel.: + 351 217 712 634
Fax: + 351 217 712 639
e-mail: ssiem2008secretariat@leading.pt

EXHIBITION & SPONSOR PACKAGE INFORMATION

Leading Congress & Association Management
Largo da Lagoa, 15 F
2795-116 Linda-a-Velha / Lisboa
Portugal

T: + 351 217 712 636
F: + 351 217 712 639
e-mail: ssiem2008exhibition@leading.pt

SCIENTIFIC PROGRAMME AND ABSTRACT SUBMISSION INFORMATION

Isabel Tavares de Almeida (Symposium President)
Margarida FB Silva (Scientific Committee member)

Centro de Patogénese Molecular - UBMBE
Faculdade de Farmácia
Universidade de Lisboa
Av. Prof. Gama Pinto,
1649-003 Lisboa
Portugal

T: + 351 217 946 400
F: + 351 217 946 491
E-mail: ssiem2008@ff.ul.pt

INFORMATION ON-LINE

www.ssiem2008.com



ABOUT LISBOA

Lisboa's location, spread over seven low hills, overlooking the river Tejo, once lured traders and settlers, and continues to be a stunning site.

Add to that the cultural diversity, a pleasantly temperate climate all year-round and a people that by longstanding tradition offer visitors a warm welcome.

Medieval Alfama is the charming and oldest part of the city with its maze-like

streets, crowned by the impressive Castelo de São Jorge. The Baixa's commercial avenues lies just below. The elegant Chiado shopping area climbs away up another hill, next to Bairro Alto, home of much of the Lisbon nightlife.

The westernmost part of the city, Belém, was the birthplace of the Age of Discoveries and Parque das Nações (the 98 World Expo site) in the northeast side of the city is an area full of 21st century avant-garde architecture built on a most impressive river side site.

A VERY BRIEF HISTORY...

Lisboa dates back to pre-Roman times - legend has it that Ulysses founded the city, although it was more probably the Phoenicians. In its early years Lisbon was a constant battleground with Phoenicians, Greeks and Carthaginians taking turn to rule the city.

In 714 the powerful Moors arrived and, by fortifying the city, held out against Christian attacks for over 400 years. By 1147 the Moors' luck turned and the Christian Crusaders recaptured Lisbon.

The 16th century was Portugal's short-lived golden era of sea exploration when riches were brought from across the oceans.

In the late 17th century the discovery of gold in Brazil saw Lisbon enjoy another luxurious period but this time it was cut short by the massive earthquake in 1755 which reduced the city to rubble.

In 1910 the monarchy fell and the first Portuguese Republic was proclaimed. Portugal's democratic phase lasted until 1926, when a military coup reduced Portugal to a period of totalitarian regime under the dictator António Salazar.

The costly colonial wars in 60's and 70's within African Portuguese territories, led to the "Carnation Revolution", a nearly bloodless military coup on 25 April 1974. The new government instituted democratic reforms and granted independence to the African colonies in 1975.

In 1986 Portugal became a full member of the European Union.



The Annual Symposium will take place at the Lisboa Congress Centre, located on the riverside in the historical neighbourhood of Belém, where some of the magnificent Portuguese World Heritage Monuments are to be found.

The congress centre can be easily reached from the city centre, by tram or bus. However during the symposium there will be a shuttle service by coach available to and from the official symposium hotels for the delegates.

REGISTRATION DESK

The registration desk will be located in the main entrance hall of the Lisboa Congress Centre. The opening hours for the symposium will be as follows:

Tuesday 2 September 2008	08h00 – 18h00
Wednesday, 3 September 2008	08h00 – 18h30
Thursday, 4 September 2008	08h00 – 15h00
Friday, 5 September 2008	08h00 – 17h00

TUESDAY, 2 SEPTEMBER 2008

- 08:00 - 09:00 Registration
- 09:00 - 12:30 **ERNDIM Meeting**
Topics to be announced
-
- 11:00 - 12:30 **Wilson's Disease Workshop**
Topics to be announced
-
- 09:00 - 12:30 **Nutrition and Dietary Treatment Workshop**
Dietary Management on Energy Metabolism Defects.
- 09:00 - 09:30 Dietary manipulation on Pyruvate Dehydrogenase complex deficiency.
W. Sperl (Salzburg, Austria)
- 09:30 - 10:00 Tolerance to fast: rational and practical evaluation in children with hypoketonemia.
J. Walter (Manchester, UK)
- 10:00 - 10:30 The role of medium-chain triglycerides in the management of energy metabolism defects.
S. Grunewald (London, UK)
- 10:30 - 11:00 Coffee Break
- Benefits and Risks of Dietetic Supplements.**
- 11:00 - 11:25 Supply of Carnitine.
F. Wijburg (Amsterdam, The Netherlands)
- 11:25 - 11:50 Supply of Creatine.
S. Stöckler (Vancouver, Canada)
- 11:50 - 12:15 Supply of long-chain polyunsaturated fatty acids (PUFA).
B. Koletzko (Munich, Germany)
- 12:15 - 12:40 B-Vitamin: manipulation of folate / homocysteine metabolism
H. Blom (Amsterdam, The Netherlands)
- 12:40 - 14:00 Lunch

12:45 - 14:10 **SSIEM Council and corresponding members meeting / Lunch**

14:15 - 14:30 **OPENING CEREMONY**

14:30 - 16:00 **PLENARY SESSION I**

Metabolic Networks and Interactions.

14:30 - 15:00 Metabolic programming: role of nutrition in the immediate postnatal life.
M. Patel (Buffalo, USA)

15:00 - 15:30 L-2- hydroxyglutaric aciduria, a disorder of metabolite repair.
E. Van Schaftingen (Brussels, Belgium)

15:30 - 16:00 Glycomics and the future of O-glycosylation defects.
J.C. Michalski (Lille, France)

16:00 - 16:30 Coffee Break

16:00 - 18:30 **PLENARY SESSION II**

Metabolic Networks and Interactions (continue).

16:30 - 17:00 Pyruvate dehydrogenase kinase 4 and its role in regulation of energy processes.
R. A. Harris (Indianapolis, USA)

17:00 - 17:30 Control of metabolic pathways through transcriptional co-factors.
S. Herzig (Heidelberg, Germany)

17:30 - 18:00 Metabolic and inflammatory control by the PPAR nuclear receptor family.
B. Staels (Lille, France)

18:00 - 18:30 Organelle dynamics: a closer link between peroxisomes and mitochondria.
M. Schrader (Aveiro, Portugal)

19:00 - 21:00 **Welcome Reception**

WEDNESDAY, 3 SEPTEMBER 2008

08:30 – 10:30

PLENARY SESSION III

Defects in the synthesis of mtDNA encoded proteins.

08:30 - 09:00

The role of mitochondrial DNA in disease.

H.J. Smeets (Maastricht, The Netherlands)

09:00 - 09:30

Aspartyl-tRNA synthase deficiency.

M. Van der Knaap (Amsterdam, The Netherlands)

09:30 - 10:00

Nuclear encoded defects in mitochondrial translation.

O. Elpeleg (Jerusalem, Israel)

10:00 - 10:30

Disorders of mtDNA maintenance.

M. Zeviani (Milan, Italy)

10:30 - 11:00

Coffee Break

11:00 – 12:30

PARALLEL SESSIONS (I + II + III + IV)

12:30 - 14:00

Lunch and Posters

12:45 - 13:55

SSIEM AGM (Annual General Meeting)

14:00 - 15:30

PARALLEL SESSIONS (V + VI + VII)

15:30 - 16:00

Coffee Break

16:00 - 18:00

PLENARY SESSION IV

Lysosomal Disorders.

16:00 - 16:30

Pathogenic cascades in Lysosomal disease – why so complex ?

S.U. Walkley (New York, USA)

16:30 - 17:00

Hermansky-Pudlak syndrome and the biogenesis of lysosome-related organelles.

E.C. Dell'Angelica (Los Angeles, USA)

17:00 - 17:30

Biogenesis and functions of exosomes in health and disease.

G. Raposo (Paris, France)

17:30 - 18:00

Niemann-Pick C disease: An example of a complex lysosomal / endosomal lipidosis.

M.T. Vanier (Lyon, France)

19:30 - 23:00

Informal Dinner

THURSDAY, 4 SEPTEMBER 2008

08:30 – 10:00

PLENARY SESSION V

Metabolic Causes of Neonatal Epilepsy.

08:30 - 09:00

Epileptogenesis: genetics, metabolism and the role of febrile seizures.

F. Lopes da Silva (Lisboa, Portugal / Amsterdam, The Netherlands)

09:00 - 09:30

Neonatal metabolic epileptic encephalopathies.

B. Plecko (Graz, Austria)

09:30 - 10:00

Treatment models for epilepsy.

P.L. Pearl (Washington, USA)

10:00 - 10:30

Coffee Break

10:30 - 12:00

PLENARY SESSION VI

HOT TOPICS

12:00 - 13:00

Lunch and Posters

13:00 - 14:30

PARALLEL SESSIONS (VIII + IX + X)

15:00 - 18:00

Excursions

20:00 - 24:00

Symposium Banquet



FRIDAY, 5 SEPTEMBER 2008

THE GARROD DAY

Inborn Errors of Metabolism
One Century after Garrod



- 09:00 - 09:20 **Introduction**
L.E. Rosenberg (Princeton, USA)
- 09:20 - 09:50 **Archibald Garrod: 1858 - 1936**
D. Galton (London, England)
- 09:50 - 10:30 **Garrod's four diseases: what has happened since?**
C. Scriver (Montreal, Canada)
- 10:30 - 11:00 **Coffee Break**
- 11:00 - 11:40 **Dominant versus recessive: molecular mechanisms in metabolic disease.**
J. Zschocke (Heidelberg, Germany)
- 11:40 - 12:20 **Synergistic heterozygosity – interaction of variants in several pathways.**
J. Vockley (Pittsburgh, USA)
- 12:20 - 13:00 **Chemical individuality – concept and outlook.**
W.A. Gahl (Bethesda, USA)
- 13:00 - 14:00 **Lunch**
- 14:00 - 15:00 **Komrower lecture.**
Mitochondrial fatty acid oxidation defects: remaining challenges.
N. Gregersen (Aarhus, Denmark)
- 15:00 - 15:30 **Awards**
2009 Presentation: ICIEM 2009, J. Vockley (Pittsburgh, USA)
- 15:30 - 15:45 **CLOSURE**
-

ERNDIM WORKSHOP

The pre-symposium annual ERNDIM workshop will be held on September 2, Tuesday morning with parallel meetings for Diagnostic Proficiency Scheme participants followed by a joint ERNDIM workshop which is open to all SSIEM participants. Participants of the Annual SSIEM Symposium who are interested in taking part in the ERNDIM workshop are kindly asked to refer either to the ERNDIM website <http://www.erndim.unibas.ch>, the Symposium website www.ssiem2008.com, where a special section will soon open and/or to contact Prof. Dr Brian Fowler, Department of Pediatrics, University of Basel (email to: brian.fowler@unibas.ch).

WILSON'S DISEASE WORKSHOP

The pre-symposium WILSON'S DISEASE workshop will be held on September 2, Tuesday morning (11:00 to 12:30). EuroWilson is the first prospective pan-European study of Wilson's disease. The workshop will review the molecular pathology of Wilson's, current diagnostic dilemmas, results of EuroWilson, and proposed trials.

DIETICIANS' WORKSHOP

In addition to the Nutrition and Dietary Treatment Workshop on the Tuesday morning, a Dieticians' Workshop will be held on the Wednesday (from 11:00 to 17:00) as one of the Parallel Sessions (IV).

In order to promote international exchange of information we are planning simultaneous translation of these presentations in English/French/German/Portuguese. This workshop will be generated from submitted abstracts and have invited speakers. Dieticians are invited to submit abstracts to any of the available categories (see pag. 14, Call for Abstracts).

Please, note that the free oral communications to be presented at the Dieticians' Workshop will be selected among the submitted abstracts in the category "Dieticians' Workshop".

If you need further information you are kindly asked to refer the Symposium website www.ssiem2008.com, where a special section will soon be opened.

CALL FOR ABSTRACTS

All abstracts describing new work relevant to inborn errors of metabolism will be considered.

Only electronic submission of abstracts will be accepted, submissions forwarded by e-mail, fax, post or courier will not be accepted.

Selected presentations will be presented in a Hot Topics Session, in Parallel Free Communication Sessions, or as a Poster.

Abstracts must be presented in English.

Abstracts should be structured and clearly state Background/Objectives, Methods, Results and Conclusions.

Abstracts stating that "Findings will be discussed..." or similar are not acceptable.

Non-standard abbreviations must be defined in the text.

Avoid single case presentations if they do not add anything to the understanding of the disease.

For abstract submission please see the symposium website www.ssiem2008.com.

Choose the option Submit an Abstract and follow the instructions carefully.

There are two options of entering your abstract text:

1. Prepare the title and the text (maximum of 250 words) in a word processing programme and then paste the text into the entry form on the website.
2. Write the title and the text directly into the entry form on the website

All entries of an abstract can be edited later, as you will be provided with a password protected access to your personal domain on the server until the deadline for the submission of abstracts: **12 May 2008**.

All types of abstracts will be processed in the same computer system.

This refers to Standard Abstracts which can be submitted as: "Oral / Poster Presentation" or "Poster - Only Presentation". Please note that accepted abstracts that do not qualify for oral presentation, will automatically be selected for poster presentation.

All submitted abstracts have to be assigned to a category. Only one category can be chosen.

- * Amino Acids
- * Homocysteine
- * Organic Acids
- * Fatty Acid Oxidation
- * Carbohydrates
- * Glycosylation
- * Mitochondrial Disorders
- * Peroxisomal Disorders
- * Creatine
- * Phenylketonuria and BH4
- * Urea Cycle Disorders
- * Lipids, Sterols, Lipoproteins
- * Lysosomes Disorders
- * Lipids, Sterols, Lipoproteins
- * Vitamins
- * Neurotransmitters
- * Organ and Cell Transplantation
- * Gene Therapy
- * Dietetics and Nutrition
- * Molecular Mechanisms
- * Gene Expression and Regulation
- * Proteins, Function and Structure
- * General Topics
- * Miscellaneous
- * Dieticians' Workshop

SELECTION OF STANDARD ABSTRACTS

The selection will be made by representatives of the SSIEM Council and of the Annual Symposium Scientific Committee. Corresponding authors will be informed of acceptance by 18 June 2008. Accepted abstracts will be given a high profile as they are published in a supplement of the Journal of Inherited Metabolic Disease.

SSIEM MATTERS AND MEMBERSHIP

The organisers encourage all participants to become a member of SSIEM, the Society for the Study of Inborn Errors of Metabolism. For further details and the application form please contact the Assistant to the Treasurer prior to the Symposium via e-mail (mailto:ssiem_mjh@onetel.com). The Assistant to the Treasurer will be available at the SSIEM desk, which will be located close to the Registration Area throughout the entire symposium.

SSIEM TRAVEL SCHOLARSHIPS

A maximum of 15 travel scholarships will be offered by SSIEM for attendance of the Annual Symposium in Lisboa.

The travel scholarships will be up to £1000 (one thousand GB pounds) to cover travel, conference registration and accommodation.

For details please visit the symposium homepage www.ssiem2008.com or the SSIEM homepage www.ssiem.org

AWARDS

Two awards of 1500 € and 500 € for the two best free presentations will be presented following the last session of the Annual Symposium 2008.

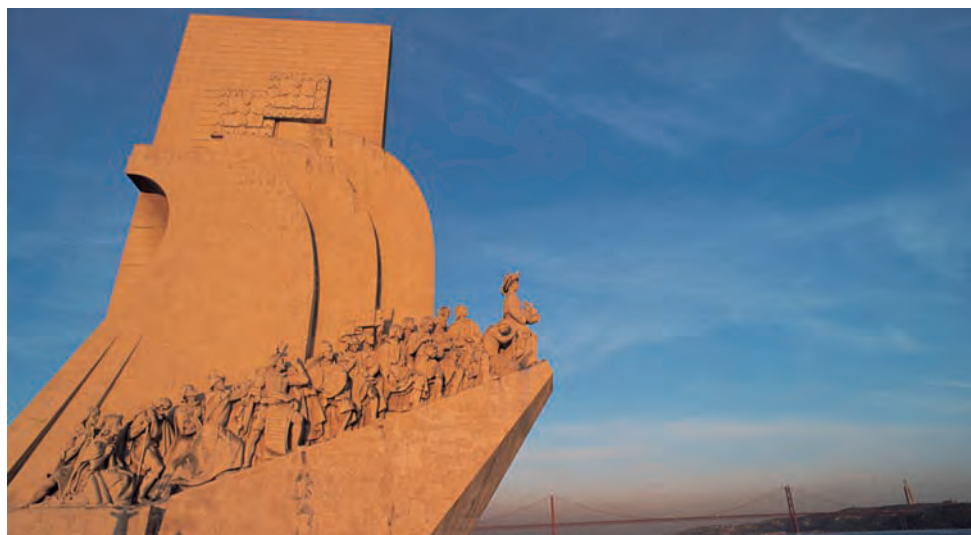

EXHIBITION INFORMATION

There will be an exhibition with partners from the industry exhibiting in Hall 4 of the Congress Centre. Please note that the exhibition will open on Tuesday morning, 2 September and remain open until the closure of the Symposium (Friday 5 September).

Representatives of companies interested in obtaining information on the Sponsors and Exhibitors Packages are kindly asked to contact Leading Congress & Association Management at ssiem2008exhibition@leading.pt.

For further contact details please see page 5.

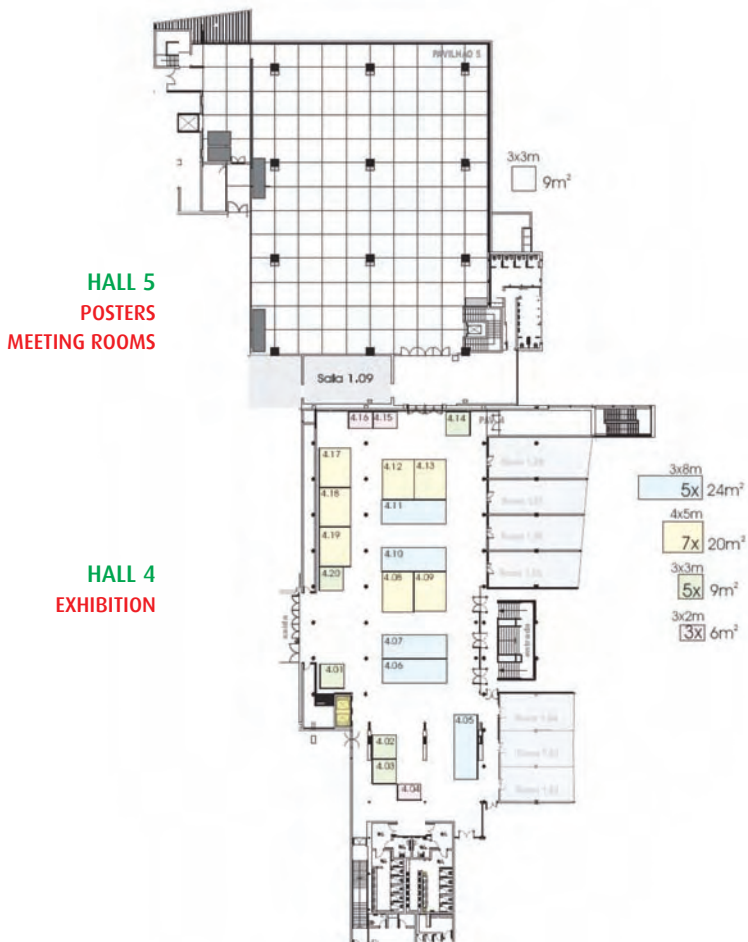

BY AIR

Lisboa lies within a couple of hours flight from most major European cities and is the closest European capital for travellers coming from the US.

The Lisboa Airport (Portela) is served by daily direct flights operated by the traditional air lines as well as by many of the low cost companies operating in Europe.

The Airport is located close to the city centre (7 km), about 15-20 min transfer to most of the centrally located hotels as well as to the Lisboa Congress Center.

The official website of Portugal's airports: www.ana.pt

OFFICIAL CARRIER



As official carrier of the SSIEM 2008 Symposium, TAP Portugal offers a special discount to all delegates and accompanying persons, who make their flight booking and buy their ticket exclusively through TAP's website.

The discounts offered are the following

10% on economy class fares

20% on business class fares

SSIEM2008 TAP booking code: IT8TPCG10

A special booking code has been given to the symposium, and this code must be mentioned when making the online booking in order to benefit from the discount.

SSIEM2008 TAP booking code: IT8TPCG10

Please see the www.ssiem2008.com website for all necessary information on the booking conditions and procedures.

BY TRAIN

Scores of national and international trains arrive to Santa Apolónia Station in Lisboa daily. The national Railroad Company (CP) provides connections covering practically the whole country as well as destinations in neighbouring Spain.

BY ROAD

Good access via various motorways and two bridges over the Tejo River – 25 de Abril and Vasco da Gama, make it easy to reach the city from anywhere in the country.

PUBLIC TRANSPORTATION

The joint fleet of the two public transportation companies Carris (buses and trams) and Metro (underground) covers the entire city with regular bus and tram routes as well as underground lines.

TAXIS

The city is served by 3,500 taxis, and a taxi ride from the airport to the city center should cost between € 8 and € 15. The usual urban taxi fares are:

Day: 2.00 € + 0.40 €/km

Telephone booking: 0.80 €

Night, weekend and holidays: 2.50 € + 0.48 €/km

For more information on the Taxi Voucher offer, please see the website of the Lisboa Tourism Board www.atl-turismolisboa.pt/taxi_voucher

Taxis are widely used by the locals, and in comparison to the taxi fares in other countries, the Lisboa taxi's are still to be considered a rather inexpensive transportation.

LISBOA CONGRESS CENTRE ACCESSIBILITY

To arrive at the Congress Centre, you may take the bus (Nr 727 and Nr 56) or the tramway (Nr 15).

The organisation of the SSIEM 2008 will provide shuttle service by coach from the official hotels to the Congress Centre and vice versa.

For further information on the schedules and departure locations please see information posted on the SSIEM 2008 web site.



Delegates wishing to register for the SSIEM 2008 Annual Symposium are invited to use the online registration form available on the official symposium website: www.ssiem2008.com or the registration form enclosed in the 2nd announcement.

Should you prefer using the enclosed registration form, we kindly ask you to complete it accordingly and return by fax to Leading Congress & Association Management (+ 351 217 712 639), at the latest by 18 August 2008.

Please note that all communications with regard of symposium registrations (on line form as well as printed form), cancellations and alterations must be forwarded in writing to Leading Congress & Association Management.

Early registration at a reduced fee will only be granted if payment is credited to the Conference Account at the latest by Monday, 30 June 2008.

The registration fees are as follows:

	Payment and registration form received until and on 30 June 2008	Payment and registration form received after 30 June 2008
SSIEM Members *	450 €	620 €
Non-Members	590 €	750 €
Students & Residents-in-Training **	320 €	450 €
Single Day Ticket	150 €	200 €
Accompanying Person	335 €	385 €

* The reduced registration fee for SSIEM members is only applicable if the annual membership fee has been paid.

** The reduced registration fee for Students & Residents-in-Training is only granted if a photocopy of the proof of students identity or statement of the head of the department is sent with the registration form to Leading Congress & Association Management per e-mail: ssiem2008secretariat@leading.pt or by fax + 351 217 712 639

Please note that full registration fee will be charged for registrations made without the above mentioned identification.

Registration Fees include:

**Full Delegate
(including SSIEM Members, Non-Members,
Students & Residents-in-Training)**

- * Admission to all oral and poster sessions and exhibition
- * The Final Programme
- * One copy of the Abstract Book
- * Coffee Breaks and Lunch box during the Symposium
- * Welcome Reception, Tuesday, 2 September
- * Informal dinner, Wednesday, 3 September
- * One excursion on Thursday afternoon, 4 September
- * Symposium Banquet , Thursday, 4 September

Single Day Ticket

- * Admission to all oral and poster sessions and exhibition
- * The Final Programme
- * One copy of the Abstract Publication
- * Coffee breaks and Lunch box on the day of the validity of the ticket

Accompanying Person

- * Welcome Reception, Tuesday, 2 September
- * Informal dinner, Wednesday, 3 September
- * One excursion on Thursday afternoon, 4 September
- * Symposium Banquet , Thursday, 4 September

CANCELLATION POLICY FOR SYMPOSIUM REGISTRATIONS

Cancellation of Registration

Cancellation request received until 31 May 2008	- 70% of the registration fee will be refunded
Cancellation request received until 31 July 2008	- 50% of the registration fee will be refunded
Cancellation request received after 31 July 2008	- no refund of the fee will be granted

“No shows” will not obtain any refund and will be handled like a cancellation made after 31 July 2008.
All cancellations must be made in writing to Leading Congress & Association Management.

HOTEL ACCOMMODATION

Hotel reservations may be made using the form available online at the SSIEM 2008 website or the enclosed registration form.

Please note that the deadline for hotel reservations within the room block for the Symposium Delegates is **30 June 2008**.

After this date we will do our best to accommodate hotel reservation requests; however we cannot guarantee to obtain confirmation at the preferred hotel or at rates indicated before 30 June 2008.

The following hotel accommodation will be available for booking on line for delegates participating in the Symposium.

HOTELS	SINGLE ROOM RATES		DOUBLE ROOM RATES	
	from	to	from	to
Hotels Category A	155 €	185 €	170 €	210 €
Hotels Category B	105 €	150 €	115 €	160 €
Hotels Category C	74 €	99 €	81 €	111 €

Hotels Category A:

Corinthia Lisboa Hotel, Dom Pedro Palace, Vila Galé Opera, VIP Grand Lisboa, Hotel Altis

Hotels Category B:

SANA Lisboa, Hotel Marques de Pombal, SANA Malhoa, SANA Reno

Hotels Category C:

Hotel Açores Lisboa, VIP Barcelona, Amazónia Lisboa, SANA Executive, VIP Zurich, VIP Berna

Student Accommodation

The organising committee has reserved a limited number of rooms at a special rate in **Luis de Camões Students Residence** of the University of Lisboa. Students and residents-in training who wish to benefit from this facility are asked to make their reservation as early as possible. Bookings will be confirmed on a first-come first-serve basis. All rooms have two (2) beds, but a room can be booked for single use.

Luis de Camões Students Residence: **45 €**

Please note that rate is quoted per room, per night. No private bath. Breakfast not included

Accommodation reservation will only be considered confirmed upon receipt of payment as follows:

If you pay by **bank transfer** – the **full amount** of your hotel reservation has to be paid together with the registration fee and accompanying person tours.

If you pay by **credit card** – **one night of your hotel reservation** will be charged together with the registration fee and accompanying person tours. The balance of your hotel reservation being automatically charged to your credit card on **1 July 2008**.

CANCELLATION POLICIES FOR HOTEL ACCOMMODATION

Please note that all bank charges involved in bank transfer actions is to be covered by the delegate.

Room cancellation received before and on 30 June 2008 will be refunded in total, deducting the cancellation fee of 15 € per room confirmed.

Room cancellation received between 01 July and 31 July 2008 will be refunded with 50 % of the total reservation cost.

Room cancellation received after 31 July 2008: No refund of payment for room reservation will be granted after this date.

If a delegate departs before the check out date marked in the hotel reservation made, the hotel is entitled to charge the guest for the whole period reserved.

Please note that hotels will charge the whole amount of the hotel reservation in case of late cancellation or "No-Show". Please see specific cancellation policies for particular hotels in the on line reservation form on the SSIEM 2008 website.

All costs arising due to alterations of existing bookings, cancellations and/or "no-shows" will be charged to the delegate.

All alterations, cancellations or other information with regard to the hotel reservation must be made in writing to Leading Congress & Association Management.

Photo Alna Mulfemans



Tuesday, 2 September

Welcome Reception - 19:00 – 21:00

Location to be confirmed

Wednesday, 3 September

Evening Event – An Enlightened Evening - 19:30 - 23:00

EDP Electricity Museum



The Tejo Power Station is one of Lisbon’s architectural landmarks and boasts a façade of undeniable beauty. In its day it was a considerable pioneer in electricity generation. Today, almost a century since it was built, the power station has again taken on innovative projects and established itself as a prominent Electricity Museum. It was re-opened to the public in May 2006, reflecting a more up-to-date concept of a museum, belonging to the EDP Foundation, a private, non-profit-making institution set up by EDP - Energias de Portugal, S.A. in December 2004.

Thursday, 4 September

Symposium Dinner - 20:00 - 24:00

Convento do Beato

The history of Convento do Beato dates back to the 16th century, when Queen D. Isabel ordered the construction of a hospice for the Blue Friars. The legend tells that, in the 16th century, Friar António set the construction of the monastery in motion with just seven “tostões” (small coins) which he had received in alms. The reputation of this miraculous building increased and people

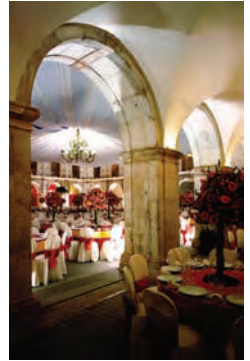

began to refer to the Friar as Beato António (António the Beatified) and his magnificent creation as the Convento do Beato. The Portuguese white marble with veins of red jasper used, gave it not only its very special look but also made it so resistant that it survived the earthquake that destroyed Lisboa in 1755.

More recently a metallic structure covered with glass was added to the large cloister creating unique space in the centre of this remarkable 16th century building.

Thursday 4 September

Afternoon Excursions - 15:00 - 18:00

Lisboa and its closest surroundings offer a large variety of interesting historical and cultural sites as well as spectacular scenic views over the Tejo River and the Atlantic Ocean.

Please make your choice of excursion when registering for the symposium.

Please note that registration for the excursion of your choice will be made on a first-come, first served basis. Should your 1st choice of excursion be fully booked at the time of your registration, the symposium organisation reserves the right to book you on your 2nd choice.

The symposium organisation reserves the right to cancel an excursion should the number of registrations not reach the minimum number required.

For more details on the Excursion Programme for Thursday afternoon, please see pages 24-27.

All excursions will depart from the Congress Center

A - WALKING TOURS (History & Architecture)

01. BELÉM



Depart from the CCL by coach towards Belém. Stop at the Tower of Belém, the Lisboa Landmark and UNESCO world heritage site, for a photograph. From here we will walk (5 minutes) to the modern 1950's Monument of the Discoveries, built to commemorate the birth date of Prince Henry the Navigator, founder of the Sagres school of navigation in the beginning of the 15th century, which played a vital role in the success of the "Portuguese Discovery Voyages" of the 15th and 16th centuries. Cross, under the railway and the road, through the tunnel to reach the gardens in front of the 16th century Jerónimos Monastery, another UNESCO world heritage site. We will visit the Church and the cloisters which remained intact even during the 1755 earthquake. We will continue our walk for a taste of the local speciality "Pastel de Belém" and a visit to the Royal Coach museum, housing one of the best coach collections in the world covering the 16th-19th centuries. The coach will then wait in front of the museum for the return journey to the Symposium hotels, on route we will drive through the centre of town for a panoramic view of the city.

02. BAIRRO ALTO & CHIADO

Depart from the CCL by coach towards the centre of Lisboa. Drive along one of the main boulevards – the Avenida da Liberdade, passing the statue of Marquês de Pombal, up to the top of the Edward VII park from where we will have a good panoramic view over the city. Return to the Restauradores Square, for a ride on one of Lisboa’s vintage elevators, still in use today as a means of public transportation. The elevator de Gloria will take us to the Bairro Alto quarter, on top of one of the famous Lisboa hills. We will continue our tour walking towards the Church of San Roque, for a visit. Then we will stop at a typical “Cervejaria” for refreshments. Arriving at the Camões Square we will walk Rua Garrett to the Baixa, the heart of Lisboa’s trade and shopping. Walk along the pedestrian street - Rua Augusta - towards the river, under the Triumphal Arch to the largest and most beautiful squares of the city – Terreiro do Paço, where coaches will be waiting to take us back to the Symposium hotels.



03. CASTELO SÃO JORGE – THE OLDEST PART OF THE CITY



Depart from the CCL by coach along the river towards the Praça do Comercio and the Cathedral where the coach will stop.

We will visit the Lisboa Se (Cathedral) and afterwards we will continue our tour walking to one of the Alfama viewpoints – the Santa Luzia, from where we will enjoy a splendid view of the eastern part of Alfama and the Tejo River.

From the view point our walk will take us to the “Castelo St Jorge”, founded in the 10th and 11th centuries, when Lisboa was an important Moorish port. In 1147, the first king of Portugal, Dom Afonso Henriques, captured both the castle and the city from the Moors. It was here that the king Dom Manuel I received Vasco da Gama after his sea voyage to India in the 16th century.

From the ramparts of the castle we will have a view over central Lisbon spread out below our feet. Return walk down hill to board the coaches which are waiting to take us back to the Symposium hotels.

B – PANORAMIC TOURS

04. SIGHTSEEING IN LISBOA (by coach)

Depart from the CCL by coach in direction of Belém, the monumental part of Lisboa, where the UNESCO world heritage sites of the Belém Tower and the Jerónimos Monastery are to be found. Monuments that remind us of the eras of the overseas voyages and discoveries of new worlds ... a brief visit to the area before continuing to the heart of Lisboa, on route we will see the beautiful Basílica de Estrela, arriving at the north-side of the Avenida da Liberdade Boulevard. One of the best viewpoints over the city is situated at the top of the Eduardo VII's Park, where we will make a stop. The coaches drive down the Avenida da Liberdade to the Rossio Square where we leave the coach for a walk along the main pedestrian street - Rua Augusta - which will take us to the Triumphal Arch opening up to the Terreiro do Paço by the river. The royal palace that stood in this magnificent square was never rebuilt after the earthquake which struck Lisboa in 1755 destroying most of the "down-town" buildings. Coaches will be waiting here for the return transfer to the Symposium hotels.



05. TRIP TO CASCAIS (by train)



Depart from CCL by coach for a short transfer to the train station of Cais do Sodré, from where the trains leave for Estoril and Cascais – the resorts on the Atlantic coast just 25 min from the centre of Lisboa. Exclusive SSIEM carriages are reserved for the train ride along the river to Cascais where we take a stroll along the beach promenade and in the picturesque pedestrian centre of Cascais - a fishing village that became a fashionable resort in the 19th century, a home to the main European exiled Royal Families. The city centre is still concentrated around the Bay of Cascais where the 2007 sailing world cup took place. Return to Lisboa and the Symposium hotels by coach.

06. LISBOA SEEN FROM THE RIVER (by boat)

Depart from CCL by coach for a short transfer to the pier where the modern yacht “Lisboa Vista do Tejo” which in translation means “Lisboa seen from the Tejo River”. Experience a two hours boat trip on the calm waters of the river enjoying a view over the riverside monuments of the city which always opens a window towards the river with a back drop of the hills where the typical old Lisboa quarters are still to be found. Refreshments will be served on board, on outside deck and in salon with panorama windows. Return transfers to the Symposium hotels by coach.



C – THEMATIC VISITS

07. NATIONAL MUSEUM of AZULEJOS (painted glazed tiles)



Depart from the CCL by coach, driving along the river for an introduction to an ancient art still visible on many Lisboa house façades. Azulejo – the word most likely has its origin in the Arabic word for al-zulej = small stone, as the original square ceramic tiles were made of many small stones bound together to form a square tile. The art was developed by the Moors living in what today is Andaluzia, in southern Spain and later on, in the 15th century, spread to the Portuguese artisans who further developed the various techniques of producing, painting and glazing the tiles. The Tiles National Museum is housed in one of Lisboa’s many old convents, the building in itself is of great interest and presents the history and the evolution of the art during centuries up until the modern design and industrial production methods of today. Coaches will take us along the city centre returning to the Symposium hotels.

08. GULBENKIAN ART MUSEUM

Depart from CCL by coach along the river for a panoramic view of the city centre. On route the coach will drive through the principal squares such as Terreiro do Paço and Rossio to reach the Avenida da Liberdade. At the upper end of the Avenue, Marquês de Pombal, the 18th century prime Minister, watches over the city from his privileged viewpoint. Another most important Lisboa personality was Calouste Gulbenkian, a wealthy 20th century oil magnate who left his invaluable private art collection to the city of Lisboa. This is a particularly beautiful collection thanks to the eclectic taste of the collector and the exquisite value of its exhibits, including Egyptian art, Chinese porcelain, Islamic carpets, European paintings dating from the Middle Ages to early 20th century and decorative art. Return to Symposium hotels by coaches.



09. PARQUE DAS NAÇÕES AND LISBOA OCEANARIUM



Depart from CCL by coach along the river, on route through the biggest square Terreiro do Paço and along the harbour until reaching the eastern part of Lisboa – the new city within the city ! What commonly still is called “the Expo” is an example of recovery of a wasted area where for many years dated military equipment was stored, in a prime location along the river. This was the area chosen to house the installations of the 1998 World Exhibition, which have been put to great use following the Expo. We will enter the area at the base of the Vasco da Gama tower overlooking the river and the bridge with the same name. We can use

the cable cars as transport and to get a better overview of the area and its many modern award-winning design buildings. The cable car will take us to one of these buildings the Oceanário, built by the American architect Chermayeff, for a visit to the wonderful oceanic underwater world. We will also be able to take a walk amongst the various installations that made up the theme of the EXPO 98’ – the Oceans. Return to the coach for transfer to the Symposium hotels.

10. LISBOA VINEYARDS ON THE SOUTH BANK OF THE RIVER

Depart from CCL by coach crossing the Tejo River through the 25th of April bridge build in the 1960’s by the US Steel Company, a “sister bridge” to the Golden Gate Bridge in San Francisco. Just across the bridge on the Palmela Peninsula we find the closest vineyards to Lisboa, famous for its fortified dessert wine “Moscatel” as well as the table wines produced in the area. We will pay a visit to one of the modern Wine cellars for a guided tour and a tasting. Return to Lisboa and the Symposium hotels this time crossing the Tejo River via the Vasco da Gama Bridge, built for the world exhibition held in Lisboa in 1998, at the time of its construction this was the longest bridge in Europe. Return to Lisboa and the Symposium hotels by coach.



Tuesday 2 September - 10:00-17:00

01. Sintra – UNESCO Heritage Site Village

Full day excursion to the romantic village of Sintra and Cabo da Roca (including lunch)



River.

We will depart from Lisboa by coach along the motorway to the beautiful town of Sintra, at the foot of the mountain range of the same name. Its unique characteristics have led UNESCO to classify it as a World heritage site, taking into account the natural riches as well as the historic buildings in the town and mountains. The luxuriant vegetation surrounds royal palaces, private mansions and romantic hide-away villas. We will visit one of the royal palaces, enjoy some free time to stroll around the narrow lanes and have lunch in royal surroundings. The westernmost point of the European mainland is Cabo da Roca. This is where the mountain ridge dives abruptly into the Atlantic Ocean forming the cliff of Cabo da Roca. This viewpoint offers a 360 ° breathtaking view over the Atlantic Ocean. From here we will return to Lisboa along the scenic road by the Tejo

Price per person (incl VAT and lunch): 98 €

02. Medieval Óbidos and Caldas da Rainha

Full day excursion to the walled Obidos village and the Thermal Spings of Caldas da Rainha (including lunch)

We will depart from Lisboa along the motorway towards the enchanting town of Óbidos filled with whitewashed houses and surrounded by a 14th-century city wall. Once a coastal town, the lagoon has silted-up over the centuries and Obidos now rests six kilometres from the sea.

The City of Caldas da Rainha owes its name to the thermal spring much loved by the Portuguese Queen D. Leonor.

Having benefited from the healing properties of waters already revered by the local population, the Queen ordered a hospital to be built in 1485, making it the oldest thermal hospital in the world. The thermal waters continue to be much sought after in our days but Caldas da Rainha is also famous for its ceramics, an industry internationally renowned for its figurative and satirical works

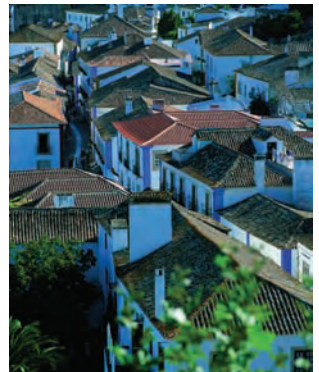

Price per person (incl VAT and lunch): 110 €

Wednesday 3 September - 10:00-17:00

03. UNESCO world heritage sites; Batalha and Alcobaça – two gothic masterpieces.

Full day excursion to the Architectural masterpieces of Batalha and Alcobaça (including lunch)



We will depart from Lisboa by coach following the motorway towards the town of Batalha. This settlement grew alongside the Monastery of Santa Maria de Vitória, built in 1386. The Portuguese King Dom João I, kept his vow to the Virgin Mary that he would build a magnificent church if Portugal defeated Castile at the Battle of Aljubarrota on 14th August 1385.

We will visit this masterpiece of Portuguese Gothic, a magnificent piece of architecture that combines various influences from its lengthy period of construction, which lasted several reigns, and is still incomplete today.

Listed by UNESCO as a World Heritage site, in 1989, Alcobaça is one of the most impressive Cistercian monasteries in Europe. Although built almost 900 years ago (construction started in 1178), the mediaeval buildings are still preserved and the church is the largest primitive Gothic church in Portugal.

The Monastery owned a vast area of land in the valley of the rivers Alcoa and Baça, where the Cistercian Order organised villages and estates, boosting agriculture development by introducing new techniques and agricultural products. This region is still today one of Portugal's main fruit producers. We will visit the mediaeval buildings, including the refectory, dormitory and chapter house as well as the magnificent kitchen.



Price per person (incl VAT and lunch): 120 €

04. Convento de Mafra and Ericeira Fishing Village

Full day excursion to the Convento de Mafra and the Fishing village of Ericeira (including lunch)



We will depart from Lisboa by coach for a short drive through the countryside to Mafra village, famous for its gigantic Palace-Convent, Portugal's largest building, built in the 18th century by order of King Dom João V. When, after three years of marriage, the King and Queen still had no children, he promised the Franciscan friars that he would build a convent in the Mafra area, if his prayers for an heir to the throne would be answered. When his daughter, Dona Maria Pia, was born, he began what was initially a quite modest convent. However, when the German architect Ludwíg was hired, the plan was considerably enlarged to a grandiose monument, including a convent for 300 friars, a basilica and a 666-room royal palace. The constructions where

accomplished in record time, from 1717 to 1730.

Ericeira is a traditional fishing village, that has seen an increasing development during the 20th century due to the growing interest in it as a summer resort. It has, however, maintained its original characteristics and its own individual atmosphere.

Its beaches are considered among the best in Europe for surfing, and where one of the World Surfing Championship contests is held every year. At lunch time we will take the opportunity to sample the locally confect fish dishes, the speciality of the regional cuisine before returning to Lisboa.



Price per person (incl VAT and lunch): 100 €

05. Évora - The Royal City

Full day excursion to Évora (including lunch)



We will depart from Lisboa by coach crossing the Tejo River via the Vasco da Gama bridge, inaugurated in 1998 in time for the World Exhibition. The motorway will take us through the undulating landscape of Alentejo directly to the city of Évora that retains the splendour of a royal city. Alentejo is the centre of the country's cork and marble production and is also famous for its wine, considered as one of the best regions for red wine production. A world of unexpected contrasts awaits us in this city with a history more than two thousand years old.

The Romans created an elegant temple, battlements and baths, and the Moorish influenced the urban planning. Conquered by the Christians in the 12th century the city captured the imagination of the kings of Portugal and several of them established their courts here. There are several convents and the one of São Francisco has one of the finest churches in Portugal. Due to its historical significance, UNESCO has classified Évora as a World Heritage site. A walking tour will take us to the most important cultural treasures.

We will enjoy lunch in a local restaurant and visit one of the wine producers in the region before returning to Lisboa.

Price per person (incl VAT and lunch): 130 €

Friday 5 September - 10:00-13:00

06. Half day Lisboa city tour

This half day tour will start with a visit to the riverside BELÉM quarter, where the famous monuments related to the Portuguese Discoveries are located, such as the Lisbon landmark, the Belém Tower, the modern Monument to the Discoveries and the magnificent 16th century Jerónimos Monastery. We will start our visit at the Belém Tower and walk to the Jerónimos Monastery.

Before the visit to the National Coach Museum we will enjoy a taste of the famous “Pasteis de Belém” – a special pastry filled with vanilla cream.

The Coach Museum is housed in the former riding school of the Belém royal palace and contains a unique collection of royal coaches, from the 17th to 19th centuries used by the Portuguese other European courts and noble houses until the introduction of the motor car. The Spanish King Philip II’s travelling coach and three monumental coaches sent by Portugal to Pope Clement XI in Rome (1716), are some of the most spectacular pieces in this incomparable collection. Our coach will be waiting outside the museum for the return transfer to the hotels.



Price per person (incl VAT): 52 €

07. Half day Excursion to Estoril & Cascais



Departure by coach from Lisboa towards Cascais, situated about 25 km from the city centre, by the Atlantic. This traditional fishing village was an important passage point for boats on their way into Lisboa since the 14th century. In the second half of the 19th century, when sea bathing became a popular activity, Cascais was transformed into a very fashionable summer resort. The main reason for this transformation being the king of Portugal, Dom Luís I, who, in 1870, converted the Fortaleza da Cidadela into his summer residence. The king’s example was immediately copied

by the nobility, who built palaces and villas that completely transformed the appearance of the former fishing village. Nowadays, Cascais is a very lively and cosmopolitan town that still preserves a great deal of its earlier aristocratic atmosphere. High quality shops and many outdoor cafés and restaurants are to be found in the pedestrian centre of the town, where we will enjoy some free time. A walk along the beach promenade that connects Cascais and Estoril is also on the programme, before returning to Lisboa via the scenic road, which runs alongside the Tejo River.

Price per person (incl VAT): 42 €



Porto and the Douro Valley

Friday, 5 - Sunday, 7 September

A visit to the birthplace of the Nation and the region of the famous Port wine. Visit on foot to the historical centre of Port, an UNESCO heritage site and a visit to the valley where the vintage port wines vineyards grow. After lunch on Sunday departure for Porto International Airport.



The unknown treasures of the Alentejo Region

Friday, 5 - Sunday, 7 September

Just across the Tejo River lies the vast Alentejo region with its characteristic landscape of cork trees and walled historical towns on top of hills. This is a region much appreciated for its gastronomy and wine production. After lunch on Sunday departure for Lisboa International Airport.

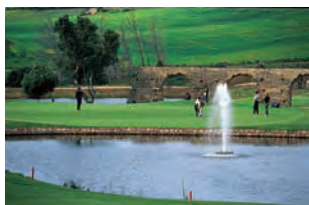

Estoril Coast with Golf

Saturday, 6 - Sunday, 7 September

SSIEM Golf tournament will be held on Saturday on one of the championship golf courses located on the Estoril Coast in the close surroundings of Lisboa. After the tournament time to relax, followed by Dinner and "Prize Award Ceremony".

Freetime on Sunday morning before individual departures from the Lisboa International Airport.

- Accessibility

Lisboa International Airport (Portela) is located 7 km and approx. 15/20 minutes drive from the city centre. Lisboa airport is served by all major international airlines with daily arrivals and departures to destinations all over the world.

- Climate

The average maximum daily temperature and average minimum temperature in the Lisboa area in September are 25°C / 77 F (high) and 18°C / 64 F (low). The area enjoys an average of 12 sunlight hours per day.

- Currency

Portugal is a member of the European Monetary System, and the previous currency Escudo was replaced by the Euro on 1 January 2002.

- Electric Current

Portuguese standard is the European type 2 pin sockets with 220 volts AC at 50 cycles. The phase 380 volt current is normally available in meeting rooms and exhibition halls.

- Exchange

Major credit cards are accepted in most hotels, shops and restaurants. Travellers' cheques and currency can be changed at exchange bureaux or at hotel receptions. Automatic changing and cash dispensing machines linked to international networks are also widely available.

- Health Requirements

With the exception of vaccination certificates for persons coming from areas where yellow fever is endemic, at the present there are no special health requirements.

- Hotel Check in/out Policy

Normal check in time at hotels is 15h00. The established check out time is 12h00.

Should you need guaranteed occupancy before 13h00 on the day of your arrival, the previous night should be reserved.

- Medical Care

Clinics and hospitals provide 24 hrs emergency service.

The national emergency phone number is 112.

Hotels have a doctor on call through the reception. Reciprocal E.C. cover is available at out-patient departments, otherwise private consultation fees are charged.

- Passport and Visas

A valid passport (or identity card for European Community citizens) is required. Visas are not necessary for citizens of EU countries, the U.S.A., Canada and most of the other countries.

Please contact your local Portuguese Embassy, Consulate or your Travel Agency for further information.

- Sales Tax

Sales tax (VAT) is included in prices quoted. For non E.U. residents, tax free shopping schemes are available in many shops, which give substantial savings to visitors.

- Shopping

Fine leather goods, lead crystal ware, porcelain, vintage wines, golden and silver filigree, pottery and textiles are considered excellent buys in Portugal.

The pedestrian streets of the city centre, "a Baixa", bordered by the magnificent Praça do Comércio, facing the River Tejo, and the "Chiado" area leading to Bairro Alto, are popular shopping areas.

Shops are open from 09h00 to 13h00 and 15h00 to 19h00 Monday to Friday, and 09h00 to 13h00 on Saturdays.

Major shopping malls stay open from 10h00 to 23h00, including weekends. The main shopping centres are Colombo, Amoreiras, Vasco da Gama and the Atrium Saldanha, all within easy access by underground network (metro).

- Smoking

The Portuguese law, in accordance with Regulations in force in the majority of European Countries and the USA, does not allow smoking in any public transportation or in any closed public areas.

- Tipping

Tipping is optional, but adding 10% to the amount is regular practise in taxis, restaurants and bars.

FOR YOUR NOTES

LOCAL TRANSPORTATION INFORMATION AND CITY MAP



SYMPOSIUM VENUE

1. Lisboa Congress Centre

HOTELS

2. Corinthia Lisboa Hotel
3. Dom Pedro Palace
4. Vila Galé Opera
5. VIP Grand Lisboa
6. Hotel Altis
7. SANA Lisboa
8. Hotel Marques de Pombal
9. SANA Malhoa
10. SANA Reno
11. Hotel Açores Lisboa
12. VIP Barcelona
13. Amazónia Lisboa
14. SANA Executive
15. VIP Zurich
16. VIP Berna
17. Luis De Camões Students Residence

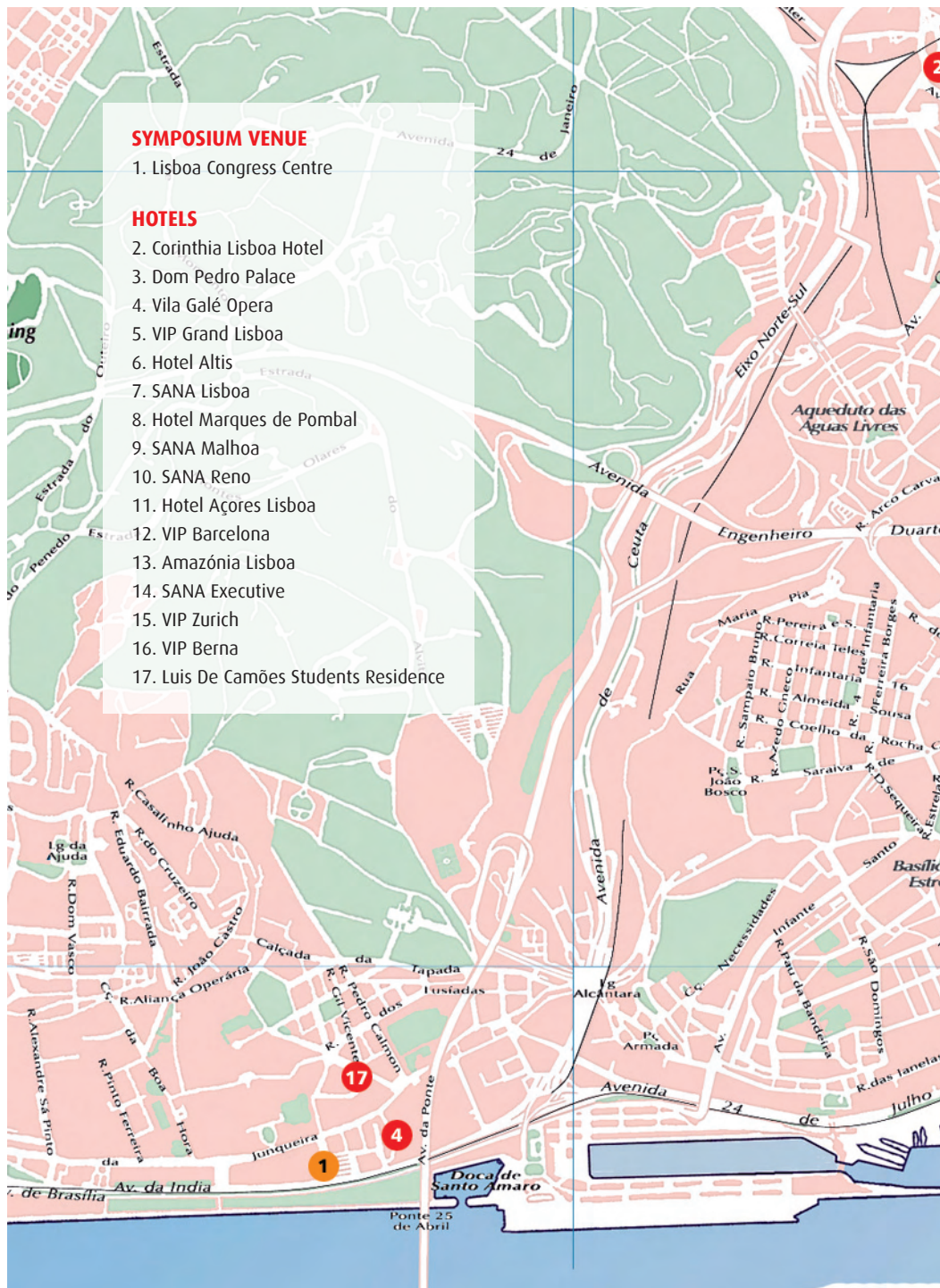



SYMPOSIUM DATES: 2 to 5 SEPTEMBER 2008

KEY DATES

22 February 2008

Opening of on-line abstract submission
and registration

18 June 2008

Abstract Notification

12 May 2008

Deadline for abstract submission

30 June 2008

Deadline for early registration
and hotel reservations



www.ssiem2008.com